

TIMBER SALE PROSPECTUS

November 9, 2017

WOOD COUNTY PARKS AND FORESTRY DEPARTMENT

**Wood County River Block Building
111 W. Jackson Street
Wisconsin Rapids, WI 54495**



BID FORMS AND RELATED DOCUMENTS

INVITATION FOR BIDS

TIMBER FOR SALE

***PLEASE NOTE NEW LOCATION FOR THE PARKS & FORESTRY OFFICE
WOOD COUNTY RIVER BLOCK, 2ND FLOOR, ROOM 202
111 W. JACKSON STREET, WISCONSIN RAPIDS, WI 54495**

Sealed bids will be received under the procedures of § 28.11 (6)(b) of Wisconsin Statutes, until **4:00 P.M., November 8, 2017** at the Wood County River Block Building, Parks and Forestry Department Office, 2nd floor, Room 202, 111 W. Jackson Street, Wisconsin Rapids, WI 54495 or hand delivered until **8:15 A.M., November 9, 2017** at the Parks and Forestry Office. **Late bids will not be accepted.** Specific information on sales, maps of the cutting areas, bid forms, cutting requirements, contract specifications, forestry policies and public participation may be obtained by contacting the Wood County Parks and Forestry Department at the Wood County River Block Building at 111 W. Jackson Street, Wisconsin Rapids, or by calling (715) 421-8422. After all information and comments on the sales are considered, **the bids will be opened in the Parks & Forestry Office at the Wood County River Block building, 2nd floor, Room 202 at 8:30 AM on November 9, 2017.**

***PLEASE NOTE: BIDDERS MAY OPERATE ATV'S ON THE COUNTY FOREST FOR THE PURPOSE OF VIEWING TIMBER SALES.**

The total acreage for sale is 304 acres with the following volumes represented (by species and product):

PULPWOOD (Tons):

Oak = 3045; Mixed Hardwood = 4445; Aspen = 3245; White Pine = 1830; Jack/Red Pine = 770

SAW TIMBER (MBF):

White Oak Saw Logs = 14; Red Maple Saw Logs = 35; Red Oak Saw Logs = 47; Black Oak Saw Logs = 151; Mixed Hardwood Saw Logs = 4;

CORDS: Dead Oak Firewood=30

Volumes listed above are based on standard utilization.

Biomass: Biomass harvest and utilization may be possible on most tracts. Those interested in biomass harvest should contact the Wood County Forest Administrator to discuss specifics of biomass harvest in relation to each particular sale. Bids will be evaluated on the value of estimated pulpwood and saw timber products.

Bids shall be filled out on bid forms provided and **include a deposit of 20% for each tract.** Bids that are not filled out completely, or are incorrect, may be subject to rejection.

All bids must be in sealed envelopes plainly marked "**Timber Sale Bid**" with **Bidders Name**. Contractors desiring to bid on more than one tract must submit separate bids and deposits on each tract. Please note appropriate tract number on each bid envelope.

Deposits for successful bids will not be returned until the provisions of the contract are fulfilled.

Utilization is required to the minimum specifications of merchantability of each species. Purchasers **MUST** provide the Forest Administrator with a certificate of insurance indicating that worker's compensation insurance coverage is provided **before contracts are issued.** Any claims of exemptions must be in compliance with State Statutes and proven in writing prior to bid. Wood County must be named as "**Additionally Insured**" on insurance

certificates. **NO EXCEPTIONS WILL BE MADE** unless specifically stated on the sale map.

Timber sale prospectus may be obtained from the Wood County Parks and Forestry Department upon request.

The Highway Infrastructure and Recreation Committee reserves the right to accept or reject any or all bids when in the best interest of Wood County.

Contractors wishing to use an Irrevocable Letter of Credit may do so as long as the following criteria are met. It is recommended that this criteria be given to the lending institution prior to that institution attempting to draft the Irrevocable Letter of Credit. This will insure that your bid will not be rejected due to an unacceptable Irrevocable Letter of Credit.

IRREVOCABLE LETTER OF CREDIT

Contents of an irrevocable letter of credit must include the following:

- A. **Must be made in favor of Wood County Parks and Forestry Department.**
- B. Letter-of-Credit number.
- C. A clear statement that it is irrevocable.
- D. Name of the bank's customer; that is the principal.
- E. Amount of credit extended (maximum limit). This limit must equal or exceed the penal sum or penalty for which the letter of credit is pledged to secure.
- F. Must cover the performance of all terms and conditions of the agreement (contract) in addition to stumpage payments.
- G. Must be negotiable for **6 months beyond the contract length** or until released by the County Forest Administrator.
- H. An authorization to draw sight drafts upon the bank in favor of Wood County Parks and Forestry Department.
- I. Must state in clear text how drafts are to be made for any default in performance of the contract.
- J. If partial collection is made on the irrevocable letter of credit, the balance will remain negotiable until the expiration of the letter.

FOREST CERTIFICATION REQUIREMENTS

Contractors must provide proof that they are SFI certified.

MILL SCALE TICKET SYSTEM

The Mill Scale Ticket system may be used if approved by the Forest Administrator in advance. All other wood will be scaled at the cutting site. Wood County no longer requires advanced payment for tickets for Contractors in good standing. Further explanation of the requirements of the ticket system may be received by contacting the Forest Administrator.

UTILIZATION SPECIFICATIONS

The following standards apply for utilization:

Aspen Pulpwood	5" top diameter inside bark
Hardwood Pulpwood	5" top diameter inside bark
Pine Pulpwood	4" top diameter inside bark
Hardwood Sawlogs	10" top diameter inside bark
Pine Sawlogs	9" top diameter inside bark

All wood that meets the minimum top diameters at 8'6" will be scaled as a sawlog regardless of the log length and top diameter.

Merchantable trees are those that have one or more 100-inch pulpwood sticks with a minimum top diameter of five inches (4" for pine).

Peeled Aspen will be billed at an additional 12.5%.

Conversion factors if used are as follows: Hardwoods 2.2 cords/thousand and Softwoods at 2.44 cords/thousand

Conversion factors for weight scaled wood are as according to the DNR Timber Sale Handbook (current year).

CONTRACT LENGTH

Tract 12-16 contract length is 2 years.

Tract 13-16 contract length is 3 years.

Tract 15-16 contract length is 3 years.

Tract 1-17 contract length is 3 years.

Tract 2-17 contract length is 3 years.

Tract 4-17 contract length is 2 years.

Tract 5-17 contract length is 2 years.

Tract 6-17 contract length is 2 years.

Wood County Forest Timber Sale Tract Locations November 2017 Bid Opening

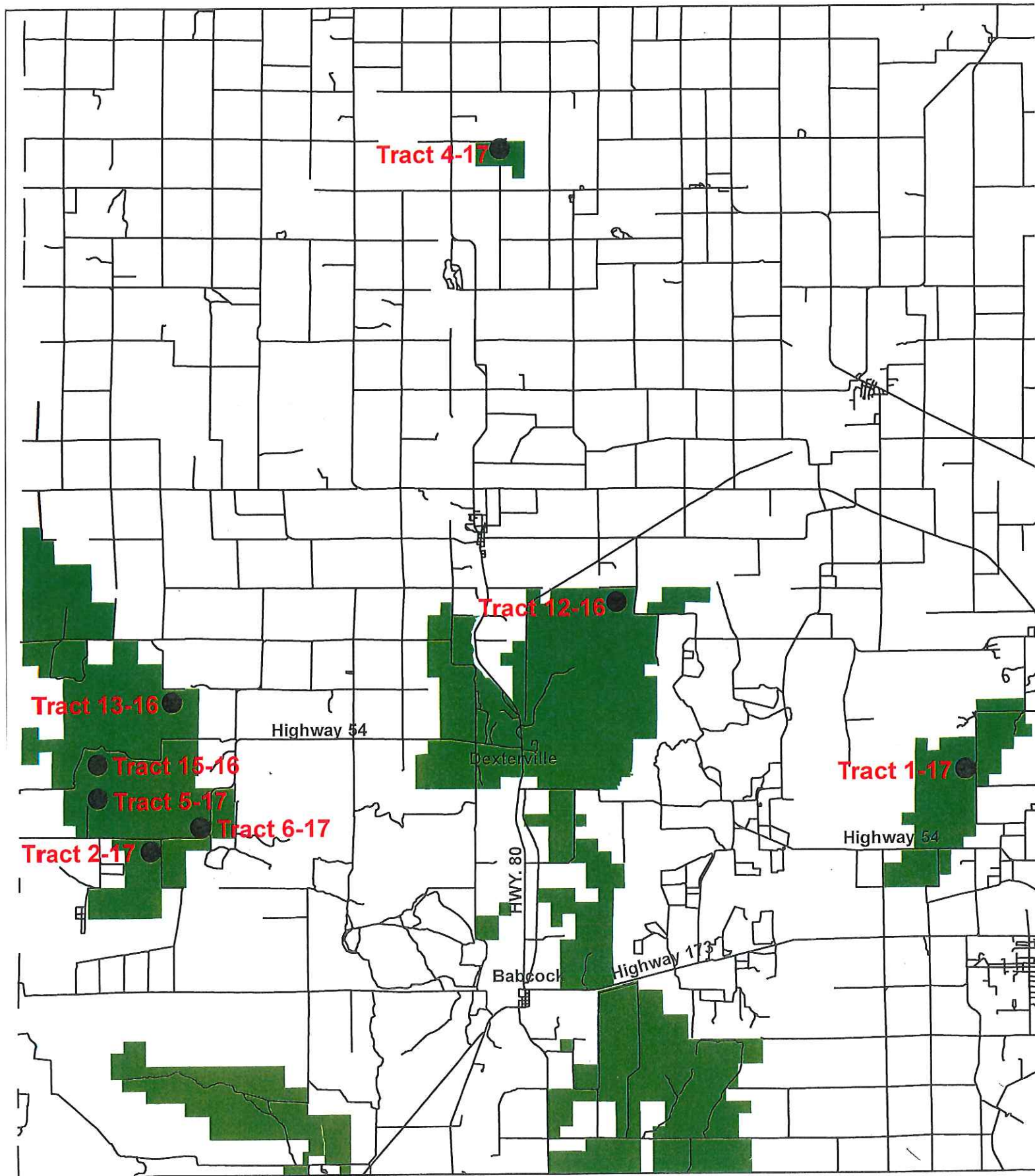

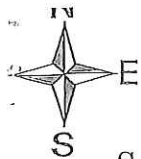

Wood County Forest Timber Sale Map

Scale: 8" = 1 mile

Sale Name: Tom's Sustainability Harvest

Sale Number:

Tract 12-16 27 acres

Contractor:

Sec: 1, T22, R3E (Dexter) and Sec. 6, T22, R4E (Seneca)

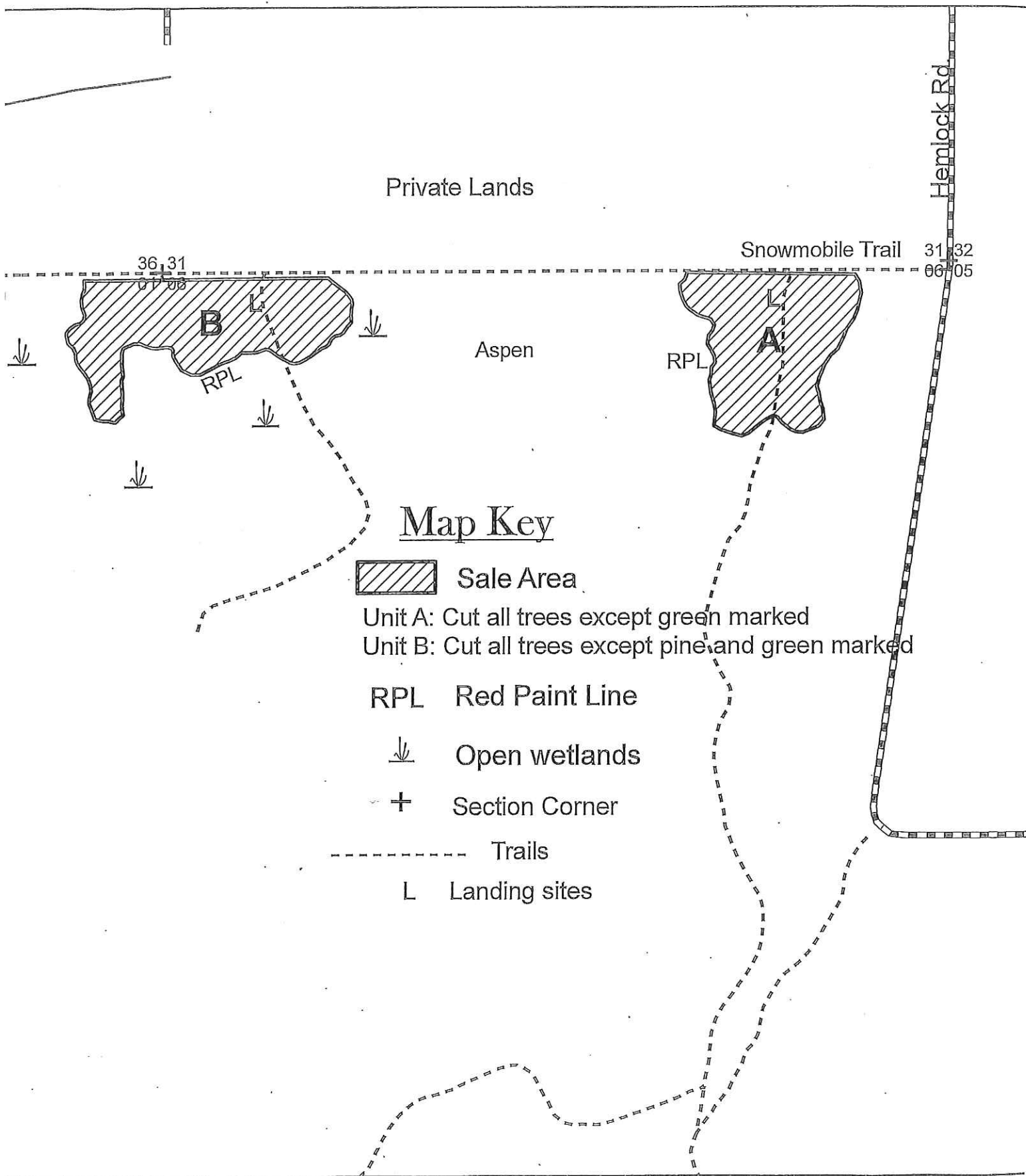

WOOD COUNTY FOREST

SALE NAME: Tom's Sustainability Sale

TRACT NUMBER: 12-16

SALE LOCATION

Wood County, Township of: Dexter and Seneca

Section: 1, T22, R3E and Section 6, T22, R4E

Sale Size: 27 Acres

SALE NUMBER _____

CONTRACTOR _____

CONTRACT PERIOD: 2 Years

PRODUCT LISTING:

Species	Estimated Volume		
	Tons 4"/5" top	Cords	MBF
Oak	400		
Aspen	180		
White Pine	170		
Mixed Hdwd.	140		
Red Oak			45
White Oak			12
TOTALS:	890		57

Note: Red oak sawlog volume is 88% red oak and 12% black oak.

MINIMUM ACCEPTABLE BID: \$26,865.00

SALE OBJECTIVES: Sale objective is to release the next stand of oak and white pine by harvesting overstory trees while protecting established regeneration as much as possible. Seed trees will be left in varying densities dependent on the degree of advance regeneration.

CUTTING AREA DESCRIPTION: The two timber sale cutting units are bounded by red paint lines on all sides except along the snowmobile trail at the north end of each unit. The harvest area consists of mature stands of red, white, and black oak mixed with scattered white pine, aspen, and red maple.

CUTTING REQUIREMENTS/SPECIFICATIONS:

- **Cutting Unit A - east cutting unit (13 acres):**
Cut all merchantable oak, mixed hardwoods, white pine, and aspen except, do not cut any tree marked with green paint. No shearing is required.
- **Cutting Units B - west cutting unit (14 acres):**
Cut all merchantable oak, aspen, and mixed hardwoods. Do not cut any white pine and any other tree marked with green paint. No shearing is required.
- Take precautions to protect advance oak and pine regeneration, especially sapling regeneration.
- Cut designated trees with one or more 100" sticks (pulp) or with one or more 8'6" sawlogs. Sawlog minimum top diameter is 10" inside bark for an 8'6" sawlog. The standard utilization is 5" minimum top diameter for aspen, oak, and mixed hardwood pulpwood, and to a 4" minimum top diameter for pine pulpwood.
- All species and products must be cut concurrently when harvesting the timber. Logs and bolts may require scaling in the field. Bolts destined to a mill that buys on weight may be allowed to go on tickets.
- All standing dead trees shall be left for wildlife values.
- Biomass harvest may be allowed on this sale, however; bids will be evaluated based on traditional forest products and volumes listed above. Contractors interested in biomass harvest should contact the forest administrator.

ACCESS: Access to the sale is from the snowmobile trail coming west off of Hemlock Rd. Landing sites are noted on the map. Landing wood along the snowmobile trail may be permitted if it can be done safely and not impact the use of the trail. No additional road building is needed.

RESTRICTIONS:

- The county may restrict the type of equipment used on the job if conditions or damage warrant.
- Seasonal Restrictions: Harvesting is not allowed from April 1 through July 15 due to oak wilt concerns. Outside of those dates, logging chance is dependent on ground and weather conditions. Soils are seasonally wet in places, especially along the snowmobile trail between the two cutting units and in portions of the western cutting unit.

OTHER SALE REQUIREMENTS AND CONDITIONS:

- None

TIMBER SALE VARIABLE UTILIZATION BID FORM

I herewith submit the following bid for timber described below:

TRACT NO. 12-16

COMMON NAME OF BIDDER (IF ANY) _____

DATE AND TIME OF BID OPENING: THURSDAY, NOVEMBER 9, 2017 AT 8:30 AM

ENCLOSED AMOUNT OF DEPOSIT (20%) \$ _____

SPECIES	<u>VOLUME</u> 4"/5" Top TONS STANDARD UTILIZATION	<u>PRICE</u> PER UNIT TOTAL	<u>VOLUME</u> MBF OR CORDS	<u>PRICE</u> PER UNIT TOTAL	TOTAL BID
OAK	400				
ASPEN	180				
WHITE PINE	170				
MIXED HARDWOOD	140				
RED OAK			45		
WHITE OAK			12		
Note: Red oak sawlog volume is 88% red oak and 12% black oak.			GRAND TOTAL:		

MINIMUM ACCEPTABLE BID: \$26,865.00

Successful bidder agrees to assume full responsibility for actions, if any, relating to Worker's Compensation, public and property damage liability, and will hold Wood County harmless against any claim arising from or connected with the above mentioned operation.

BIDDER'S SIGNATURE _____ E-MAIL ADDRESS _____

MAILING ADDRESS _____ CITY, STATE, ZIP _____

TELEPHONE NUMBER _____ CELL PHONE _____

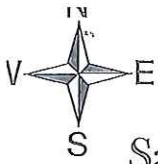

Wood County Forest Timber Sale Map

Scale: 8" = 1 mile

Sale Name: Squatchy Oak Sale

Tract 13-16 56 acres

Sec. 15 and 16, T22, R2E, Town of Hiles

Sale Number:

Contractor:

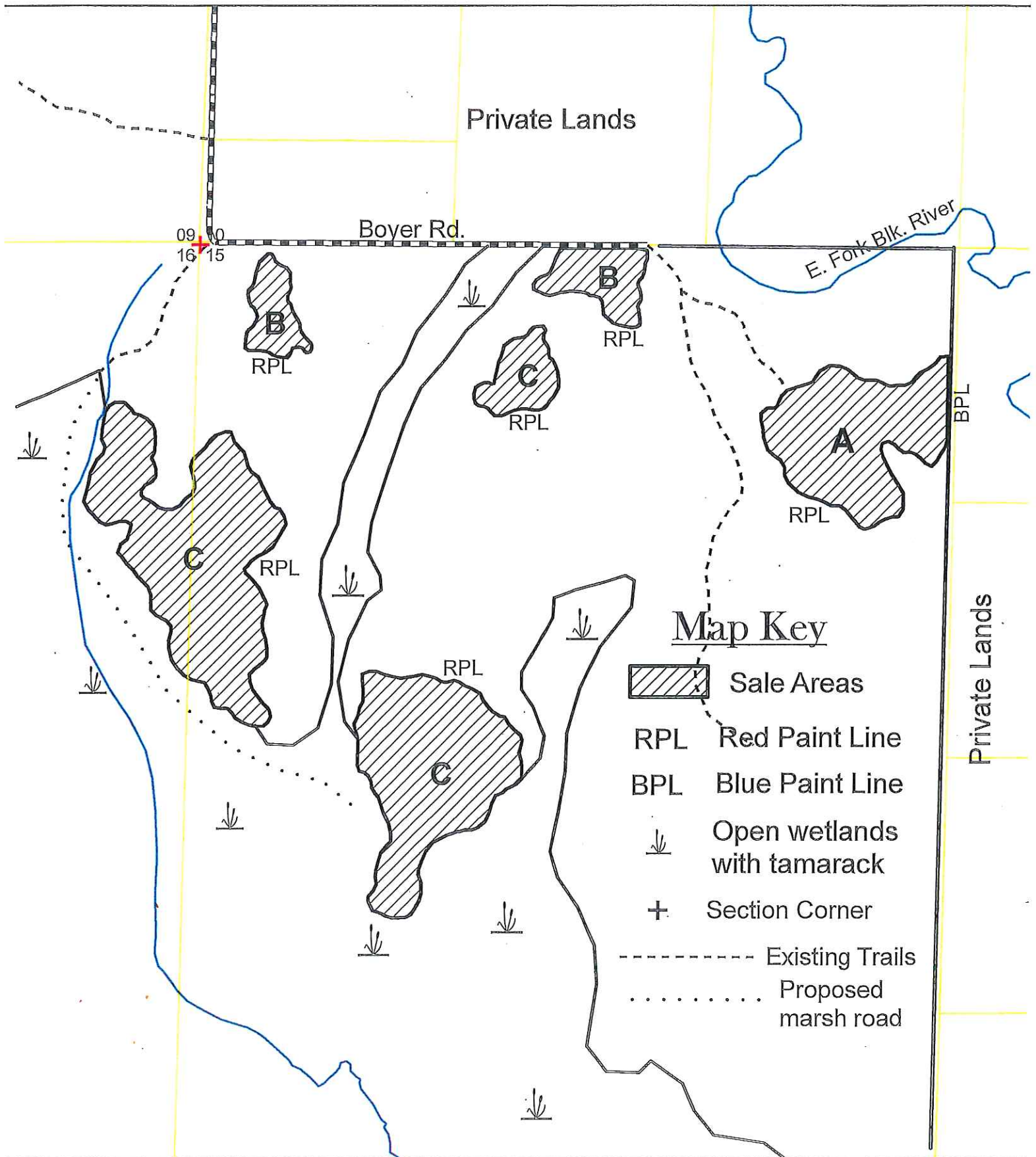

WOOD COUNTY FOREST

SALE NAME: Squatchy Oak Sale

TRACT NUMBER: 13-16

SALE LOCATION

Wood County, Township of Hiles

Section: 15 and 16, T22, R2E

Sale Size: 56 Acres

SALE NUMBER _____

CONTRACTOR _____

CONTRACT PERIOD: 3 Years

PRODUCT LISTING:

Species	<u>Estimated Volume</u>		
	Tons 4"/5" top	Cords	MBF
Mixed Hwd.	1250		
Oak	450		
Aspen	150		
Oak			65
Red Maple			25
TOTALS:	1850		90

*Note: 52% of the aspen volume is big-tooth aspen.
Oak sawlog volume is 52% black oak, 47% red oak, and
1% white oak.*

MINIMUM ACCEPTABLE BID: \$36,915.00

SALE OBJECTIVES: The general sale objective is to release the next stand of oak and white pine by harvesting overstory trees while protecting established regeneration as much as possible. Seed trees will be left in varying densities dependent on the degree of advance regeneration.

CUTTING AREA DESCRIPTION: There are six patches to harvest with three cutting prescriptions. Red and blue paint lines mark the boundaries of all cutting units. The harvest area consists of mature stands of red, white, and black oak mixed with scattered white pine, aspen, and red maple.

CUTTING REQUIREMENTS/SPECIFICATIONS:

- Cutting Unit A - east cutting unit (12 acres):
This unit lies adjacent to private lands to the east of the county forest. Cut all merchantable aspen and mixed hardwoods. Cut only those oak marked with orange paint and, cut all ironwood 2" in diameter or larger. Do not cut any white pine and any other tree marked with green paint. Other than ironwood, no shearing is required.
- Cutting Units B - cutting units along Boyer Rd. (6 acres):
Cut all merchantable oak, aspen, and mixed hardwoods. Do not cut any white pine, and any other tree marked with green paint. Shearing is required of all aspen and mixed hardwood >2" in diameter.
- Cutting Units C - units located south of Boyer Rd. (38 acres)
Cut all merchantable black and red oak, aspen, and mixed hardwoods. Do not cut any white pine, white oak, and any other tree marked with green paint. No shearing is required.
- Take precautions to protect advance oak and pine regeneration, especially sapling regeneration.
- Cut designated trees with one or more 100" sticks (pulp) or with one or more 8'6" sawlogs. Sawlog minimum top diameter is 10" inside bark for an 8'6" sawlog. The standard utilization is 5" minimum top diameter for aspen, oak, and mixed hardwood pulpwood.
- All species and products must be cut concurrently when harvesting the timber. Logs and bolts may require scaling in the field. Bolts destined to a mill that buys on weight may be allowed to go on tickets.
- All standing dead trees shall be left for wildlife values.
- Biomass harvest may be allowed on this sale, however; bids will be evaluated based on traditional forest products and volumes listed above. Contractors interested in biomass harvest should contact the forest administrator.

ACCESS: Access to the sale is from Boyer Road and forest roads coming south from Boyer Rd. The contractor will need to freeze a marsh road to access the two southern-most cutting units. Landing sites must be approved by the forest administrator.

RESTRICTIONS:

- The county may restrict the type of equipment used on the job if conditions or damage warrant.
- Seasonal Restrictions: Harvesting is not allowed from April 1 through July 15 due to oak wilt concerns. Outside of those dates, logging chance is dependent on ground and weather conditions. This is likely a winter only sale for a majority of the harvest acreage.

OTHER SALE REQUIREMENTS AND CONDITIONS:

- None

TIMBER SALE VARIABLE UTILIZATION BID FORM

I herewith submit the following bid for timber described below:

TRACT NO. 13-16

COMMON NAME OF BIDDER (IF ANY) _____

DATE AND TIME OF BID OPENING: THURSDAY, NOVEMBER 9, 2017 AT 8:30 AM

ENCLOSED AMOUNT OF DEPOSIT (20%) \$ _____

SPECIES	<u>VOLUME</u> 4"/5" Top TONS STANDARD UTILIZATION	<u>PRICE</u> PER UNIT TOTAL	<u>VOLUME</u> MBF OR CORDS	<u>PRICE</u> PER UNIT TOTAL	TOTAL BID
MIXED HARDWOOD	1250				
OAK	450				
ASPEN	150				
OAK			65		
RED MAPLE			25		
Note: 52% of the aspen volume is big-tooth aspen. Oak sawlog volume is 52% black oak, 47% red oak, and 1% white oak.		GRAND TOTAL:			

MINIMUM ACCEPTABLE BID: \$36,915.00

Successful bidder agrees to assume full responsibility for actions, if any, relating to Worker's Compensation, public and property damage liability, and will hold Wood County harmless against any claim arising from or connected with the above mentioned operation.

BIDDER'S SIGNATURE _____ E-MAIL ADDRESS _____

MAILING ADDRESS _____ CITY, STATE, ZIP _____

TELEPHONE NUMBER _____ CELL PHONE _____

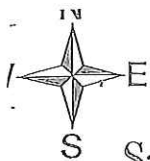

Wood County Forest Timber Sale Map

Scale: 8" = 1 mile

Sale Name: Frozen Tundra Sale

Tract 15-16 84 acres

Sec. 20 and 29, T22, R2E, Town of Hiles

Sale Number:

Contractor:

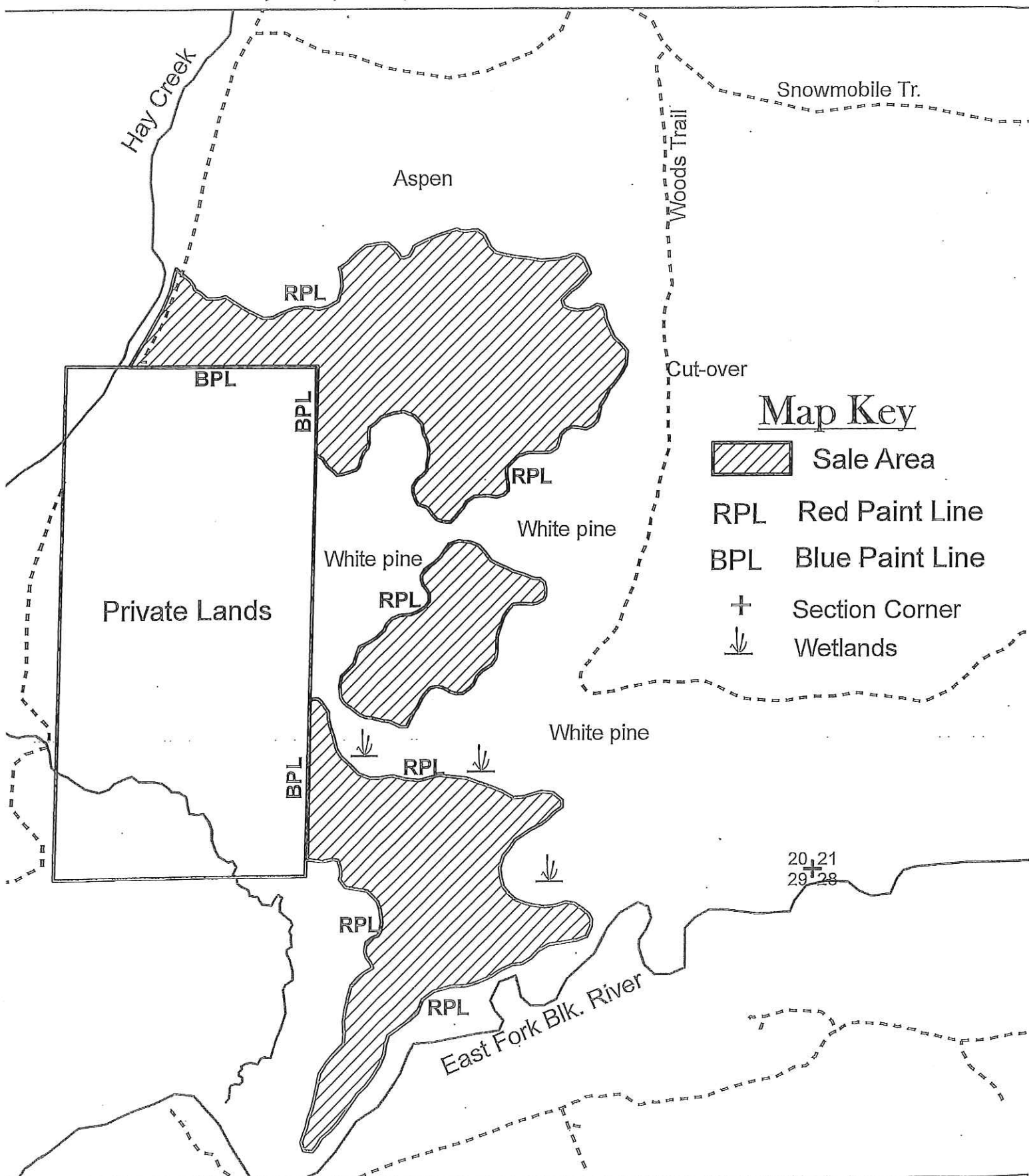

WOOD COUNTY FOREST

SALE NAME: Frozen Tundra Sale

TRACT NUMBER: 15-16

SALE LOCATION

Wood County, Township of: Hiles

Section: 20 and 29, T22, R2E

Sale Size: 84 Acres

SALE NUMBER _____

CONTRACTOR _____

CONTRACT PERIOD: 3 Years

PRODUCT LISTING:

Species	<u>Estimated Volume</u>		
	Tons 4"/5" top	Cords	MBF
Aspen	1150		
Oak	1100		60
Mixed Hwd.	700		
White Pine	20		
Red Maple			10
TOTALS:	2970		70

Note: 58% of the aspen volume is big-tooth aspen. Oak sawlog is black oak

MINIMUM ACCEPTABLE BID: \$35,662.00

SALE OBJECTIVES: The sale objective is to regenerate oak, aspen, and white pine forests using coppice and over-story removal harvests. Other objectives are to maintain mature oak and pine for wildlife values and to protect water quality in Hay Creek and East Fork Black River.

CUTTING AREA DESCRIPTION: There are three cutting units with boundaries marked by red or blue paint lines. The sale lies adjacent to a privately owned 80 acre parcel. The harvest areas consist of mature oak, aspen, and maple stands.

CUTTING REQUIREMENTS/SPECIFICATIONS:

- Cut all merchantable black oak, aspen, and mixed hardwoods. Do not cut any white pine, white oak, and any other tree marked with green paint. No shearing is required.
- Take precautions to protect advance oak and pine regeneration, especially sapling regeneration.
- Cut designated trees with one or more 100" sticks (pulp) or with one or more 8'6" sawlogs. Sawlog minimum top diameter is 10" inside bark for an 8'6" sawlog. The standard utilization is 5" minimum top diameter for aspen, oak, and mixed hardwood pulpwood, and 4" minimum top diameter for pine.
- All species and products must be cut concurrently when harvesting the timber. Logs and bolts may require scaling in the field. Bolts destined to a mill that buys on weight may be allowed to go on tickets.
- All standing dead trees shall be left for wildlife values.
- No slash can be left across the blue paint lines.
- Biomass harvest may be allowed on this sale, however; bids will be evaluated based on traditional forest products and volumes listed above. Contractors interested in biomass harvest should contact the forest administrator.

ACCESS: Access to the sale is from a snowmobile trail coming off of Peterson Road. Additional road building will be needed to gain access into the cutting units. Landing sites must be approved by the forest administrator.

RESTRICTIONS:

- The county may restrict the type of equipment used on the job if conditions or damage warrant.
- Seasonal Restrictions: Harvesting will be confined to July 16 through March 31 when ground conditions will support logging operations. It is likely harvesting will be restricted to winter months due to difficult access and wet site conditions between cutting units.

OTHER SALE REQUIREMENTS AND CONDITIONS:

- None

TIMBER SALE VARIABLE UTILIZATION BID FORM

I herewith submit the following bid for timber described below:

TRACT NO. 15-16

COMMON NAME OF BIDDER (IF ANY) _____

DATE AND TIME OF BID OPENING: THURSDAY, NOVEMBER 9, 2017 AT 8:30 AM

ENCLOSED AMOUNT OF DEPOSIT (20%) \$ _____

SPECIES	<u>VOLUME</u> 4"5" Top TONS STANDARD UTILIZATION	<u>PRICE</u> PER UNIT TOTAL	<u>VOLUME</u> MBF OR CORDS	<u>PRICE</u> PER UNIT TOTAL	TOTAL BID
ASPEN	1150				
OAK	1100		60		
MIXED HARDWOOD	700				
WHITE PINE	20				
RED MAPLE			10		
Note: 58% of the Aspen volume is big-tooth Aspen. Oak sawlog is black oak.		GRAND TOTAL:			

MINIMUM ACCEPTABLE BID: \$35,662.00

Successful bidder agrees to assume full responsibility for actions, if any, relating to Worker's Compensation, public and property damage liability, and will hold Wood County harmless against any claim arising from or connected with the above mentioned operation.

BIDDER'S SIGNATURE _____ E-MAIL ADDRESS _____

MAILING ADDRESS _____ CITY, STATE, ZIP _____

TELEPHONE NUMBER _____ CELL PHONE _____

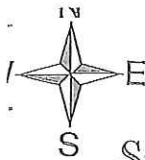

Wood County Forest Timber Sale Map

Scale: 8" = 1 mile

Sale Name: Adam's Aspen Sale

Tract 1-17 95 acres

Sec. 20, T22, R5E, Town of Seneca

Sale Number:

Contractor:

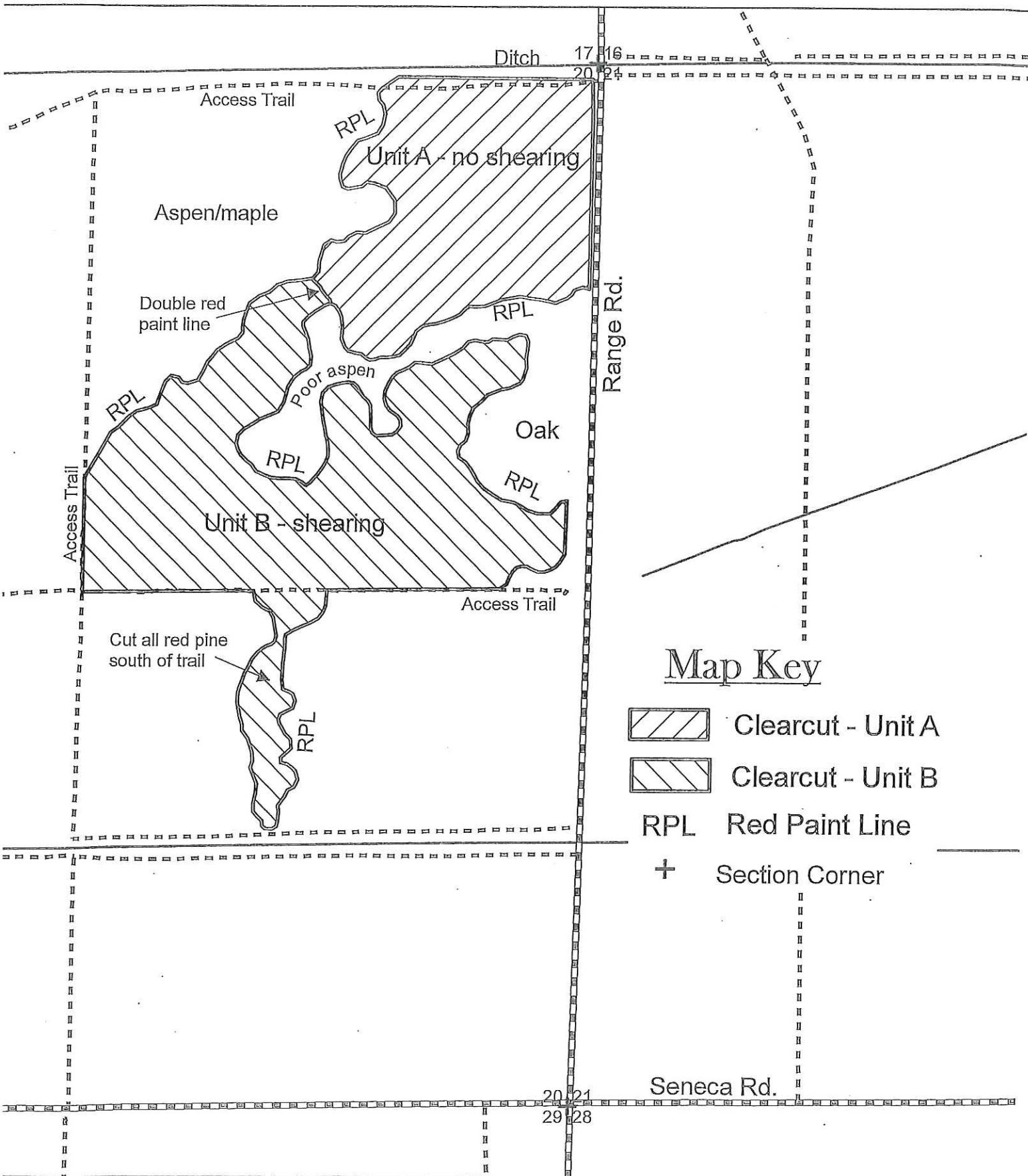

SALE NAME: Adam's Aspen Sale

TRACT NUMBER: 1-17

SALE LOCATION

Wood County, Township of: Seneca

Section: 20 Town: 22 Range: 5E

Sale Size: 95 Acres

SALE NUMBER _____

CONTRACTOR _____

CONTRACT PERIOD: 3 Years

PRODUCT LISTING:

Species	<u>Estimated Volume</u>		
	Tons 4"/5" top	Cords	MBF
Mixed Hdwd.	1500		
Aspen	1180		
Oak	460		
Jack Pine / Red Pine	200		
TOTALS:	3340		

MINIMUM ACCEPTABLE BID: \$34,494.00

SALE OBJECTIVES: The sale objective is to regenerate aspen and maple using coppice and overstory removal harvest systems, while maintaining mature oak and pine for wildlife values and aesthetics.

CUTTING AREA DESCRIPTION: The timber sale area consists of aspen and red maple with scattered oak and patches of pine. Red maple saplings are well established in the understory over most of the sale area. The sale is broken into two cutting units which are separated from each other with a double red paint line (see map). A red paint line bounds the sale area on all sides except along Range Rd.

CUTTING REQUIREMENTS/SPECIFICATIONS:

- **Cutting Unit A - Aspen Clearcut (no shearing required - 35 acres):**
Cut all merchantable aspen, mixed hardwood, black oak, and jack pine. Cut only those red pine marked with orange paint. Do not cut any white pine or any oak marked with green paint. No shearing is required.
- **Cutting Unit B - Aspen Clearcut (shearing required - 60 acres):**
Cut all merchantable aspen, mixed hardwood, black oak, and jack pine. Cut only those red pine marked with orange paint, except cut all merchantable red pine south of the access trail (see map). Do not cut any white pine or any oak marked with green paint. Shearing of all stems other than pine, 2" in diameter or larger is required.
- Cut designated trees with one or more 100" sticks. The standard utilization is 5" minimum top diameter for aspen, oak, and mixed hardwood pulpwood, and to a 4" minimum top diameter for pine pulpwood.
- All species and products must be cut concurrently when harvesting the timber. Logs and bolts may require scaling in the field. Bolts destined to a mill that buys on weight may be allowed to go on tickets.
- All standing dead trees shall be left for wildlife values.
- Biomass harvest may be allowed on this sale, however, bids will be evaluated based on traditional forest products and volumes listed above. Contractors interested in biomass harvest should contact the forest administrator.

ACCESS: Access to the sale is from several woods trails coming off of Range Rd. These access trails are bermed and the contractor will need to open the roads prior to harvest. Some additional road work may be needed to improve the access trails for use. Landing sites may be located along these access trails.

RESTRICTIONS:

- The county may restrict the type of equipment used on the job if conditions or damage warrant.
- Seasonal Restrictions: No harvesting is allowed from April 1 through July 15 due to oak wilt concerns. Outside of these dates, harvesting is dependent on ground and weather conditions. Soils are seasonally wet over most of the sale area.

OTHER SALE REQUIREMENTS AND CONDITIONS:

- None

TIMBER SALE VARIABLE UTILIZATION BID FORM

I herewith submit the following bid for timber described below:

TRACT NO. 1-17

COMMON NAME OF BIDDER (IF ANY) _____

DATE AND TIME OF BID OPENING: THURSDAY, NOVEMBER 9, 2017 AT 8:30 AM

ENCLOSED AMOUNT OF DEPOSIT (20%) \$ _____

SPECIES	<u>VOLUME</u> 4"/5" Top TONS STANDARD UTILIZATION	<u>PRICE</u> PER UNIT TOTAL	<u>VOLUME</u> MBF OR CORDS	<u>PRICE</u> PER UNIT TOTAL	TOTAL BID
MIXED HARDWOOD	1500				
ASPEN	1180				
OAK	460				
JACK/RED PINE	200				
			GRAND TOTAL:		

MINIMUM ACCEPTABLE BID: \$34,494.00

Successful bidder agrees to assume full responsibility for actions, if any, relating to Worker's Compensation, public and property damage liability, and will hold Wood County harmless against any claim arising from or connected with the above mentioned operation.

BIDDER'S SIGNATURE _____ E-MAIL ADDRESS _____

MAILING ADDRESS _____ CITY, STATE, ZIP _____

TELEPHONE NUMBER _____ CELL PHONE _____



Wood County Forest Timber Sale Map

Scale: 16" = 1 mile

Sale Name: Clyde's Got a Gun Pine Sale

Sale Number:

Tract 2-17 42 acres

Contractor:

Sec. 33, T22, R2E, Town of Hiles

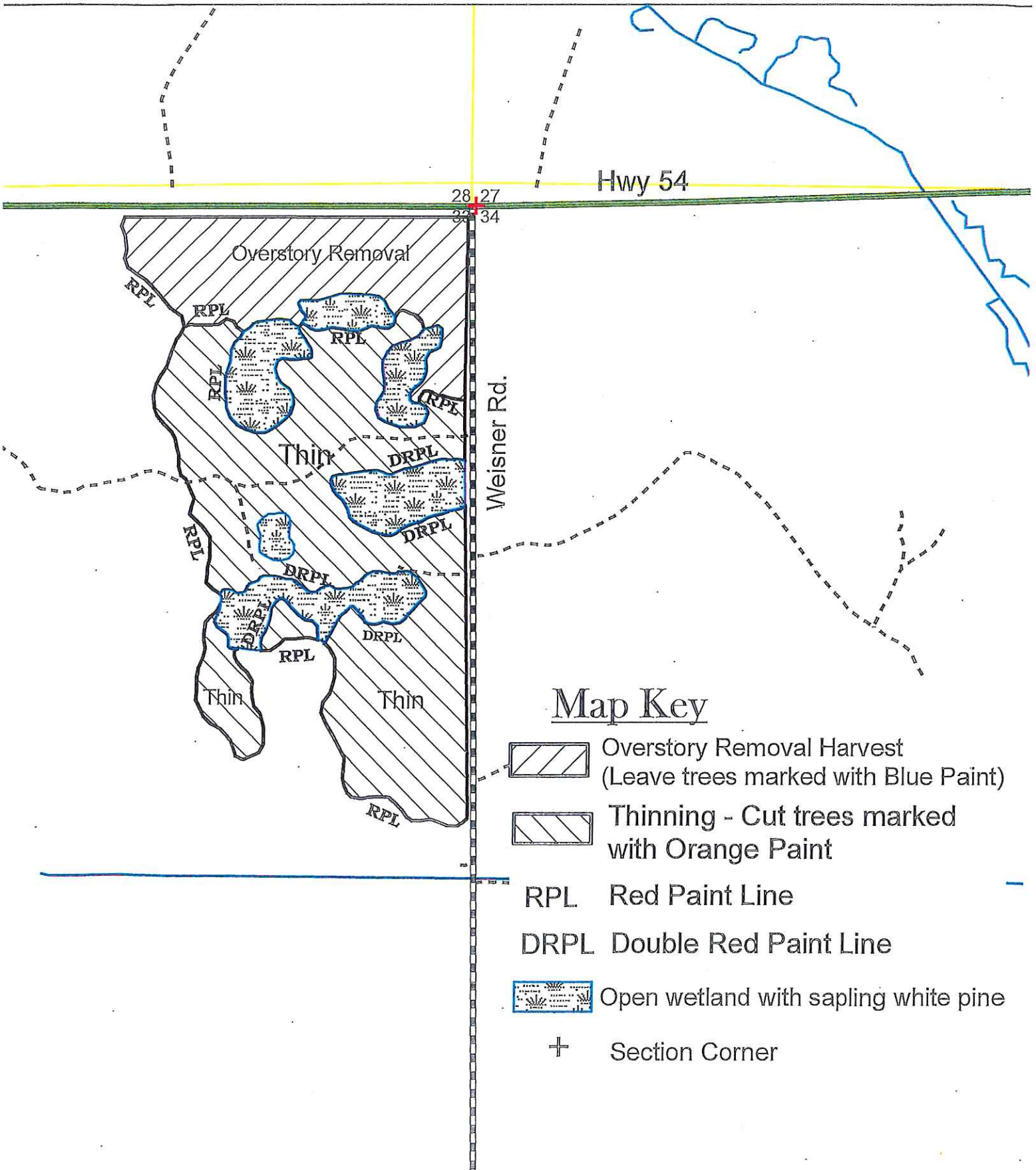

WOOD COUNTY FOREST

Page 1 of 1

SALE NAME: Clyde's Got a Gun Pine Sale

TRACT NUMBER: 2-17

SALE LOCATION

Wood County, Township of: Hiles

Section: 33 Town: 22 Range: 2E

Sale Size: 42 Acres

SALE NUMBER _____

CONTRACTOR _____

CONTRACT PERIOD: 3 Years

PRODUCT LISTING:

Species	<u>Est. Volume</u>				
	Tons				
	4"/5" top				
White Pine	930				
Oak	65				
Aspen	15				
Mixed Hdwd.	15				
TOTALS:	1025				

Note: white pine volume contains an estimated 50 tons of red pine

MINIMUM ACCEPTABLE BID: \$24,290.00

SALE OBJECTIVES: The harvest area consists of white pine plantations. The objective of the harvest is to thin the pine stands on 30 acres to improve future timber quality and to release white pine regeneration with an overstory removal harvest on 12 acres.

CUTTING AREA DESCRIPTION: The sale boundary is marked with red paint lines. There is also a red paint line between the Thinning Unit and the Overstory Removal Unit. In addition, there are no-cut areas with scattered large white pines and dense white pine saplings designated with a double red paint line facing into the Thinning Unit. Other more open wetlands do not have paint lines around them and are shown on the sale map. These white pine stands have been thinned once previously. In the overstory removal harvests, cut trees average 14" dbh and 6 to 7 pulpsticks. In the thinning areas, cut trees average 8-10" dbh and 4 to 6 pulpsticks.

CUTTING REQUIREMENTS/SPECIFICATIONS:

- **Thinning Unit (30 acres):** Cut all merchantable aspen and mixed hardwoods; cut only those white pine, red pine, and oak marked with orange paint.
- **Overstory Removal Unit (12 acres):** Cut all merchantable trees taking care to minimize damage to white pine regeneration. Do not cut any tree marked with **BLUE** paint.
- Cut designated trees with one or more 100" sticks (pulp). The standard utilization is 5" minimum top diameter for aspen, oak, and mixed hardwood pulpwood, and to a 4" minimum top diameter for pine pulpwood.
- Pine products must be removed from the sale area within two weeks of harvest between April 1st and August 31st to minimize bark beetle buildup.
- All species and products must be cut concurrently when harvesting the timber. Logs and bolts may require scaling in the field. Bolts destined to a mill that buys on weight may be allowed to go on tickets.

ACCESS: Access to the sale is from woods roads coming west off of Weisner Rd. (see map). Landing sites can be established along these logging roads and must be approved by the forest administrator.

RESTRICTIONS:

- The county may restrict the type of equipment used on the job if conditions or damage warrant.
- Seasonal Restrictions: Logging chance is dependent on ground and weather conditions. Soils are poorly drained in areas. Due to these issues - logging may be limited to winter months.

OTHER SALE REQUIREMENTS AND CONDITIONS:

- The logging contractor will be responsible for treating cut pine stumps with sporax or Cellu-Treat to prevent infection from Annosum root rot. Application of the fungicide is required on all pine stumps within 24 hours of cutting from April 1st through November 30th. Wood County will provide the fungicide if needed. Contractor should contact the forest administrator in advance to ensure an adequate supply is on hand.

TIMBER SALE VARIABLE UTILIZATION BID FORM

I herewith submit the following bid for timber described below:

TRACT NO. 2-17

COMMON NAME OF BIDDER (IF ANY) _____

DATE AND TIME OF BID OPENING: THURSDAY, NOVEMBER 9, 2017 AT 8:30 AM

ENCLOSED AMOUNT OF DEPOSIT (20%) \$ _____

SPECIES	<u>VOLUME</u> 4"/5" Top TONS STANDARD UTILIZATION	<u>PRICE</u> PER UNIT TOTAL	<u>VOLUME</u> MBF OR CORDS	<u>PRICE</u> PER UNIT TOTAL	TOTAL BID
WHITE PINE	930				
OAK	65				
ASPEN	15				
MIXED HARDWOOD	15				
			GRAND TOTAL:		

MINIMUM ACCEPTABLE BID: \$24,290.00

Successful bidder agrees to assume full responsibility for actions, if any, relating to Worker's Compensation, public and property damage liability, and will hold Wood County harmless against any claim arising from or connected with the above mentioned operation.

BIDDER'S SIGNATURE _____ E-MAIL ADDRESS _____

MAILING ADDRESS _____ CITY, STATE, ZIP _____

TELEPHONE NUMBER _____ CELL PHONE _____

Sale Number:
Contractor:

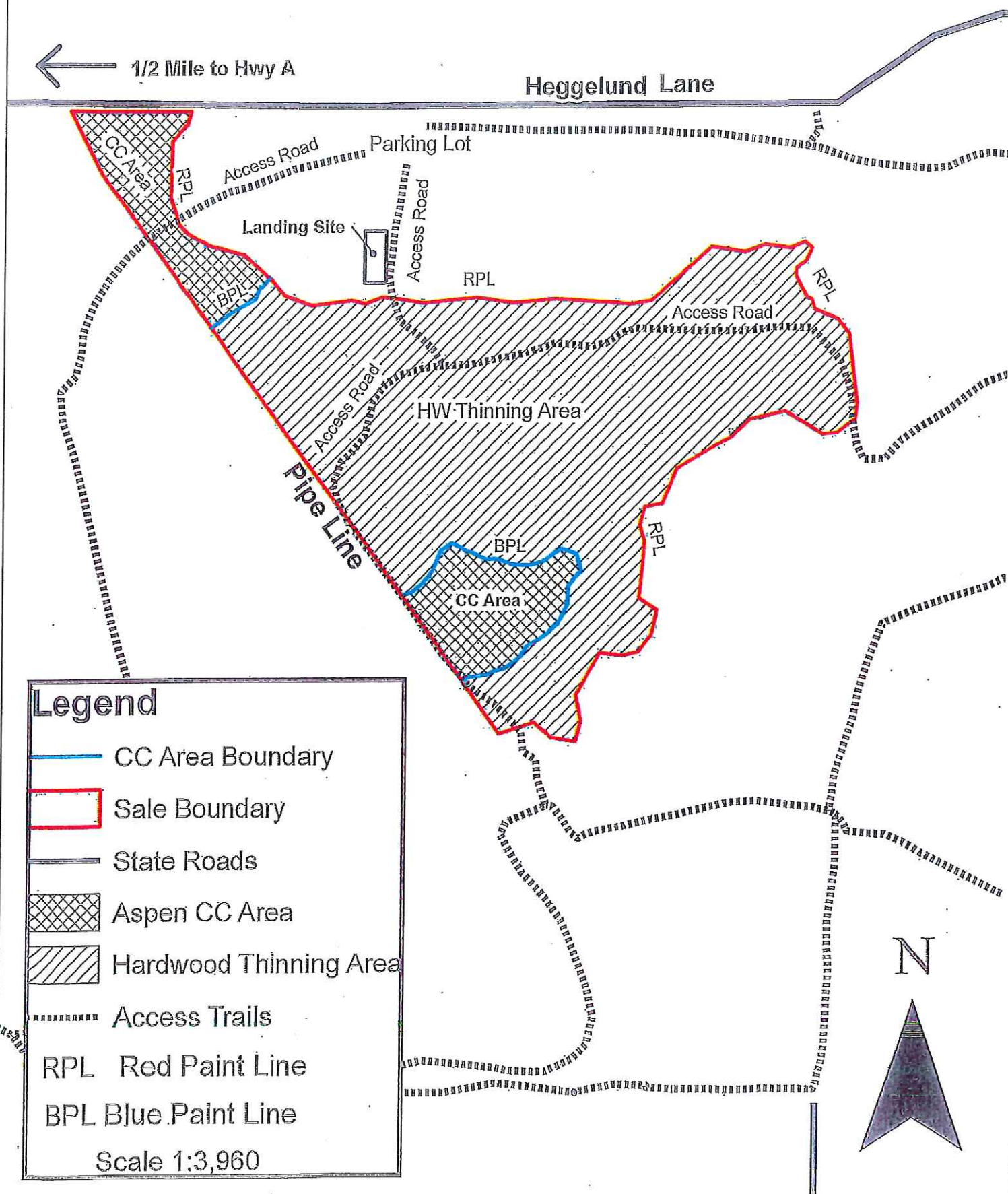

SALE NAME: Steve's Bottoms-Up Sale

TRACT NUMBER: 4-17

SALE LOCATION

Wood County, Township of: Richfield

Section: 22 Town: 24N Range: 3E

Sale Size: 27 Acres

SALE NUMBER _____

CONTRACTOR _____

CONTRACT PERIOD: 2 Years

PRODUCT LISTING:

Species	<u>Est. Volume</u> Tons 4"/5" top	Cords	MBF
Mixed Hdwd	460		
Aspen	460		
Oak	80		
White Oak Logs			2
Red Oak Logs			2
Mixed Hdwd Logs			4
TOTALS:	1000		8

Note: Mixed hardwood sawlog volume includes red maple, black ash, white ash, green ash, white birch, basswood and elm.

MINIMUM ACCEPTABLE BID: \$14,360.00

SALE OBJECTIVES: The sale objectives include: Thin oak and hardwood stands to improve growth and future timber quality. Regenerate stands of aspen using coppice harvest. Protect water quality in Puff Creek.

CUTTING AREA DESCRIPTION: Exterior cutting boundaries are delineated by red paint lines. Blue paint lines separate oak/hardwood thinning area from aspen coppice areas. Enbridge pipeline lies to the southwest of cutting units. Cutting units are located on gently sloping topography. Lower portions of the sale area are fairly wet and may contain wet seeps. Soils are heavy and can remain wet throughout summer months depending on the year. Aspen volume contains a fair amount of bigtooth aspen with good bolt potential.

CUTTING REQUIREMENTS/SPECIFICATIONS:

- **Hardwood/Oak marked thinning (23 acres):** Cut all merchantable aspen and all other trees marked with orange paint. Care must be taken to avoid damage to residual trees.
- **Aspen coppice units (4 Acres):** Cut all trees 2" diameter and larger within cutting unit boundaries (see map).
- Cut and utilize designated trees with one or more 100" sticks (pulp) or with one or more 8"6" sawlogs. Sawlog minimum top diameter is 10" inside the bark for an 8"6" sawlog. The standard utilization is 5" minimum top diameter for aspen, oak, and mixed hardwood pulpwood.
- All species and products must be cut concurrently when harvesting the timber. Logs and bolts may require scaling in the field. Bolts destined to a mill that buys on weight may be allowed to go on tickets.
- Several cross-country ski trails and hiking trails run through the sale area. Be aware that it may be necessary to coordinate cutting operations with trail use depending on snow conditions and timing of harvest. Trail closure is possible with advance notice. **Do not leave slash or other debris on trails. Trails must be left in good condition upon completion of harvest activity.**

ACCESS: Access to the sale area lies south off of Heggelund Lane. A good landing site exists just north of the harvest area and south of the pine plantation and parking lot. It should not be necessary to cross the pipeline, however communication with local Enbridge representatives will be necessary if skidding parallel to pipeline along fringe of right-of-way is desired.

RESTRICTIONS:

- The county may restrict the type of equipment used on the job if conditions or damage warrant.
- Seasonal Restrictions: Harvesting is not allowed from April 1 through July 15 due to oak wilt concerns. Outside of those dates logging chance is dependent on ground conditions.

OTHER SALE REQUIREMENTS AND CONDITIONS:

- Contractors should be aware that buckthorn is present within the sale area. Some discussion/planning will be necessary in order to limit its spread. Best management practices for invasive species are routinely included in the standard Wood County Forest Timber Sale Contract.

TIMBER SALE VARIABLE UTILIZATION BID FORM

I herewith submit the following bid for timber described below:

TRACT NO. 4-17

COMMON NAME OF BIDDER (IF ANY) _____

DATE AND TIME OF BID OPENING: THURSDAY, NOVEMBER 9, 2017 AT 8:30 AM

ENCLOSED AMOUNT OF DEPOSIT (20%) \$ _____

SPECIES	<u>VOLUME</u> 4"/5" Top TONS STANDARD UTILIZATION	<u>PRICE</u> PER UNIT TOTAL	<u>VOLUME</u> MBF OR CORDS	<u>PRICE</u> PER UNIT TOTAL	TOTAL BID
MIXED HARDWOOD	460				
ASPEN	460				
OAK	80				
WHITE OAK LOGS			2		
RED OAK LOGS			2		
MIXED HWD LOGS			4		
			GRAND TOTAL:		

MINIMUM

ACCEPTABLE BID: \$14,360.00

Successful bidder agrees to assume full responsibility for actions, if any, relating to Worker's Compensation, public and property damage liability, and will hold Wood County harmless against any claim arising from or connected with the above mentioned operation.

BIDDER'S SIGNATURE _____ E-MAIL ADDRESS _____

MAILING ADDRESS _____ CITY, STATE, ZIP _____

TELEPHONE NUMBER _____ CELL PHONE _____

Sale Name: Bear Hunters Paradise
Tract 5-17 Acres 30
Sec. 29 T22N R3E Town of Hiles

Wood County Forest Timber Sale Map

Sale Number:
Contractor

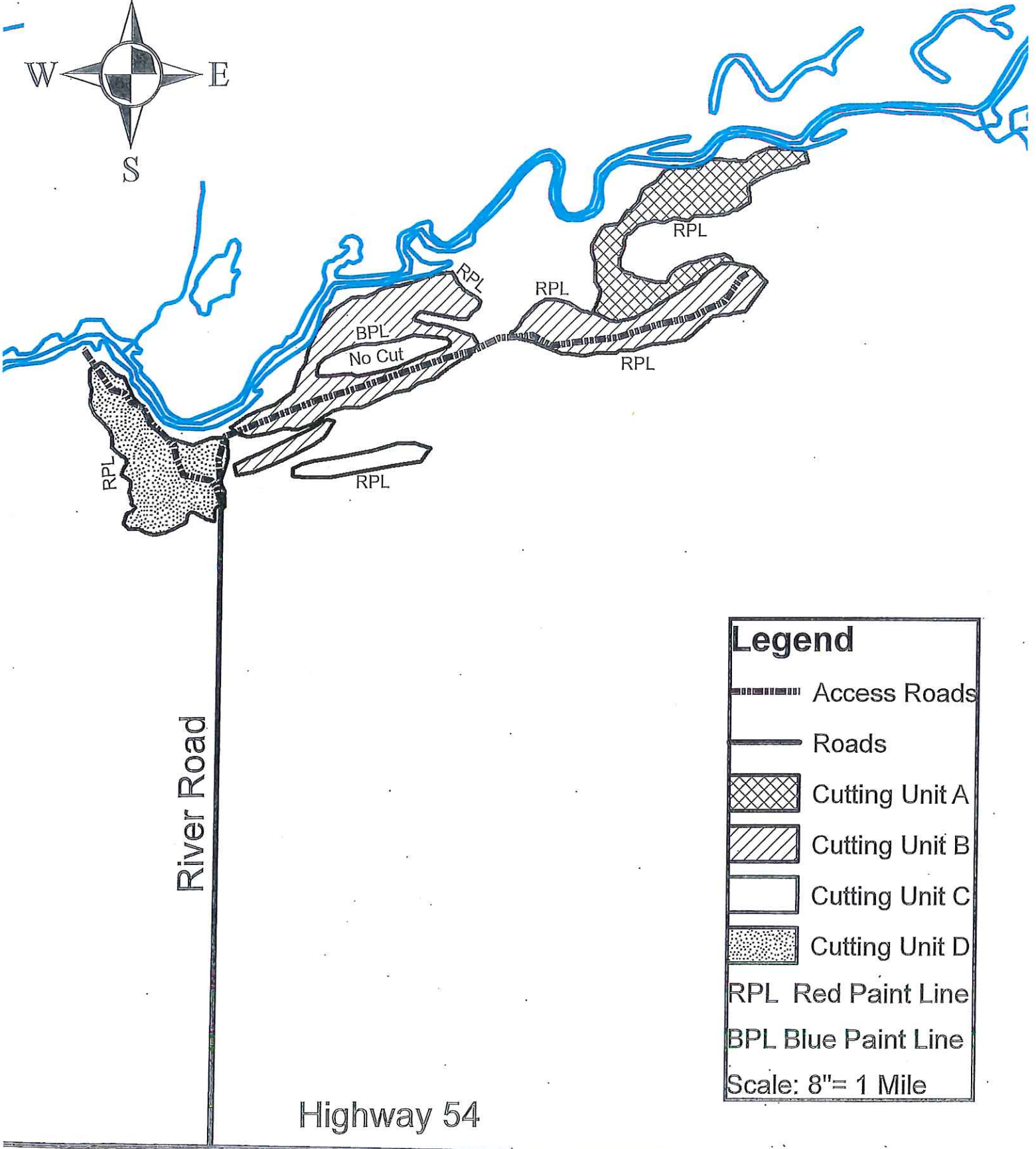
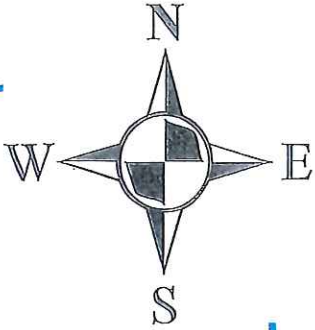

Legend

- Access Roads
- Roads
- Cutting Unit A
- Cutting Unit B
- Cutting Unit C
- Cutting Unit D
- RPL Red Paint Line
- BPL Blue Paint Line
- Scale: 8"= 1 Mile

SALE NAME: Bear Hunters Paradise Sale

TRACT NUMBER: 5-17

SALE LOCATION

Wood County, Township of: Hiles

Section: 29 Town: 22N Range: 3E

Sale Size: 30 Acres

SALE NUMBER _____

CONTRACTOR _____

CONTRACT PERIOD: 2 Years

PRODUCT LISTING:

Species	Est. Volume	Cords	MBF
	Tons 4"/5" top		
Red Pine	470		
Oak	430		26
Mixed Hdwd	350		4
Aspen	100		
Dead Oak Firewood		30	
TOTALS:	1350	30	30

Note: Red pine volume contains a small amount of white pine and jack pine.

MINIMUM ACCEPTABLE BID: \$26,950.00

SALE OBJECTIVES: The sale objectives include: Thin pine plantations to improve red pine growth and future timber quality. Regenerate stands and release advance oak regeneration using combination overstory removal and seed tree harvest. Protect water quality in East Fork Black River.

CUTTING AREA DESCRIPTION: Exterior cutting boundaries are delineated by red paint lines. Blue paint lines delineate no cut zone. Cutting units are composed of pine plantations in need of thinning and mature oak stands containing a mix of oak, red maple, and white pine advance regeneration. Cutting units are located on flat to gently sloping topography. Portions of the sale area may contain wet pockets, however most summers they dry up and can easily be worked around.

CUTTING REQUIREMENTS/SPECIFICATIONS:

- Unit "A" Oak seed tree/ overstory removal (6 acres): Cut all merchantable black oak, mixed hardwood, jack pine, red pine, and aspen. Do not cut any white oak, white pine, and any other tree marked with green paint.
- Unit "B" Red pine thinning (16 acres): Cut all merchantable aspen, birch, jack pine, and any tree marked with orange paint. Machinery may not be operated in the no cut zone delineated by blue paint line (see map).
- Unit "C" Red Pine final harvest (1 acre): Cut all merchantable trees including those with red paint marks.
- Unit "D" Oak overstory removal (7 acres): Cut all merchantable black oak, mixed hardwood, aspen, and jack pine. Do not cut any white pine, red pine, white oak, and any other tree marked with green paint.
- Cut and utilize designated trees with one or more 100" sticks (pulp) or with one or more 8"6" sawlogs. Sawlog minimum top diameter is 10" inside the bark for an 8"6" sawlog. The standard utilization is 5" minimum top diameter for aspen, oak, and mixed hardwood pulpwood and 4" minimum top diameter for pine pulpwood.
- Pine products must be removed from the sale area within two weeks of harvest between April 1st and August 31st to minimize build up of bark beetle populations.
- All species and products must be cut concurrently when harvesting the timber. Logs and bolts may require scaling in the field. Bolts destined to a mill that buys on weight may be allowed to go on tickets.

ACCESS: Access to the sale area is from a woods road that extends north from the end of River Road. A small amount of road improvement may be necessary depending on contractors skidding plans. Wood may be decked along woods road and within landing sites existing from previous harvests.

RESTRICTIONS:

- The county may restrict the type of equipment used on the job if conditions or damage warrant.
- Seasonal Restrictions: Harvesting is not allowed from April 1 through July 15 due to oak wilt concerns. Outside of those dates logging chance is dependent on ground conditions.

OTHER SALE REQUIREMENTS AND CONDITIONS:

- The logging contractor will be responsible for treating cut pine stumps with an approved fungicide to prevent infection from Annosum Root Disease. Application of fungicide is required on all pine stumps within 24 hours of cutting from April 1st through November 30th. Wood County will provide Cellutreat fungicide if needed. Contractor should contact the forest administrator in advance to insure an adequate supply is on hand.

TIMBER SALE VARIABLE UTILIZATION BID FORM

I herewith submit the following bid for timber described below:

TRACT NO. 5-17

COMMON NAME OF BIDDER (IF ANY) _____

DATE AND TIME OF BID OPENING: THURSDAY, NOVEMBER 9, 2017 AT 8:30 AM

ENCLOSED AMOUNT OF DEPOSIT (20%) \$ _____

SPECIES	<u>VOLUME</u> 4"/5" Top TONS STANDARD UTILIZATION	<u>PRICE</u> PER UNIT TOTAL	<u>VOLUME</u> MBF OR CORDS	<u>PRICE</u> PER UNIT TOTAL	TOTAL BID
RED PINE	470				
OAK	430		26		
MIXED HDWD	350		4		
ASPEN	100				
DEAD OAK FIREWOOD			30		
			GRAND TOTAL:		

MINIMUM ACCEPTABLE BID: \$26,950.00

Successful bidder agrees to assume full responsibility for actions, if any, relating to Worker's Compensation, public and property damage liability, and will hold Wood County harmless against any claim arising from or connected with the above mentioned operation.

BIDDER'S SIGNATURE _____ E-MAIL ADDRESS _____

MAILING ADDRESS _____ CITY, STATE, ZIP _____

TELEPHONE NUMBER _____ CELL PHONE _____

Sale Name: Four Seasons Pine
Tract 6-17 Acres 44
Sec 26,27,34 T22N R3E

Wood County Forest Timber Sale Map

Sale Number:
Contractor:

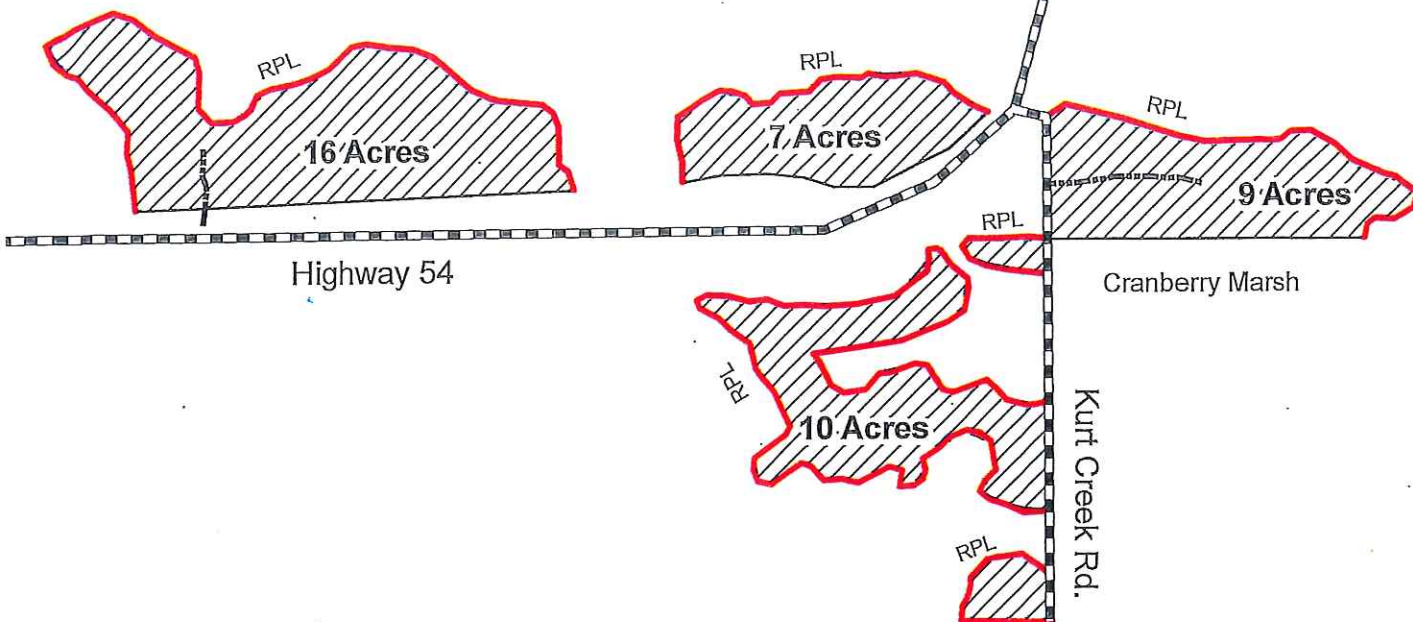
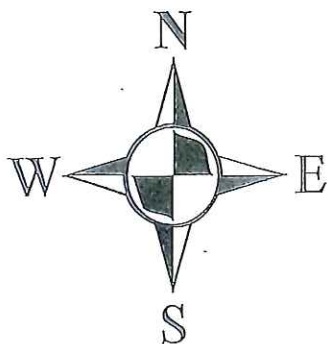

Legend

— Sale Area Boundary

— Roads

▨ Sale Area

— Access Trails

RPL Red Paint Lines

Scale: 8" = 1 Mile

WOOD COUNTY FOREST

Page 1 of 1

SALE NAME:Four Seasons Pine

TRACT NUMBER: 6-17

SALE LOCATION

Wood County, Township of: Hiles

Section: 26,27,34 Town: 22N Range: 3E

Sale Size: 44 Acres

SALE NUMBER _____

CONTRACTOR _____

CONTRACT PERIOD: 2 Years

PRODUCT LISTING:

Species	<u>Est. Volume</u>				
	Tons				
4"/5" top					
White Pine	710				
Red Pine	100				
Oak	60				
Aspen	10				
Mixed Hdwd.	30				
Total Tons	910				

MINIMUM ACCEPTABLE BID: \$14,048.00

SALE OBJECTIVES: The harvest areas are bounded by red paint and consist primarily of White Pine. The objective of the harvest is to thin the pine stands on 44 acres to improve future timber quality and to release white pine regeneration.

CUTTING AREA DESCRIPTION: The sale area consists of 44 acres in six cutting areas. All areas are primarily White Pine and all will have the same cutting requirements listed below. All six sale areas will have good access directly off of Highway 54 or Kurt Creek Road.

CUTTING REQUIREMENTS/SPECIFICATIONS:

- Cut all trees marked with orange paint.
- Do not cut any trees marked with Red paint.
- Cut all merchantable Aspen.
- Care must be taken to avoid damage to existing areas of White Pine regeneration.
- Cut designated trees with one or more 100" sticks (pulp). The standard utilization is 5" minimum top diameter for aspen, and to a 4" minimum top diameter for pine pulpwood.
- Pine products must be removed from the sale area within two weeks of harvest between April 1st and August 31st to minimize bark beetle buildup.
- All species and products must be cut concurrently when harvesting the timber. Logs and bolts may require scaling in the field. Bolts destined to a mill that buys on weight may be allowed to go on tickets.

ACCESS: Access to the sale is directly off of Highway 54 and Kurt Creek Road. All access and landings must be approved by county forest administrator.

RESTRICTIONS:

- The county may restrict the type of equipment used on the job if conditions or damage warrant.
- Seasonal Restrictions: Logging chance is dependent on ground and weather conditions. Soils are poorly drained in areas. Due to these issues - logging may be limited to winter months.

OTHER SALE REQUIREMENTS AND CONDITIONS:

- The logging contractor will be responsible for treating cut pine stumps with sporax or Cellu-Treat to prevent infection from Annosum root rot. Application of the fungicide is required on all pine stumps within 24 hours of cutting from April 1st through November 30th. Wood County will provide the fungicide if needed. Contractor should contact the forest administrator in advance to ensure an adequate supply is on hand.

TIMBER SALE VARIABLE UTILIZATION BID FORM

I herewith submit the following bid for timber described below:

TRACT NO. 6-17

COMMON NAME OF BIDDER (IF ANY) _____

DATE AND TIME OF BID OPENING: THURSDAY, NOVEMBER 9, 2017 AT 8:30 AM

ENCLOSED AMOUNT OF DEPOSIT (20%) \$ _____

<u>SPECIES</u>	<u>VOLUME</u> 4"/5" Top TONS STANDARD UTILIZATION	<u>PRICE</u> PER UNIT TOTAL	<u>VOLUME</u> MBF OR CORDS	<u>PRICE</u> PER UNIT TOTAL	<u>TOTAL BID</u>
WHITE PINE	710				
RED PINE	100				
OAK	60				
ASPEN	10				
MIXED HDWD	30				
GRAND TOTAL:					

MINIMUM ACCEPTABLE BID: \$14,048.00

Successful bidder agrees to assume full responsibility for actions, if any, relating to Worker's Compensation, public and property damage liability, and will hold Wood County harmless against any claim arising from or connected with the above mentioned operation.

BIDDER'S SIGNATURE _____ E-MAIL ADDRESS _____

MAILING ADDRESS _____ CITY, STATE, ZIP _____

TELEPHONE NUMBER _____ CELL PHONE _____

BLANK BID FORM

TRACT NO. _____

THURSDAY, NOVEMBER 9, 2017 AT 8:30 AM

ENCLOSED AMOUNT OF DEPOSIT (20%) \$ _____

	<u>VOLUME</u>	<u>PRICE</u>	<u>VOLUME</u>	<u>PRICE</u>	
	TONS STANDARD UTILIZATION	PER UNIT TOTAL	MBF OR CORDS	PER UNIT TOTAL	TOTAL BID
SPECIES					
GRAND TOTAL:					

MINIMUM ACCEPTABLE BID: \$ _____

Successful bidder agrees to assume full responsibility for actions, if any, relating to Worker's Compensation, public and property damage liability, and will hold Wood County harmless against any claim arising from or connected with the above mentioned operation.

BIDDER'S SIGNATURE _____

E-MAIL ADDRESS _____

MAILING ADDRESS _____

CITY, STATE, ZIP _____

TELEPHONE NUMBER _____

CELL PHONE _____

BLANK BID FORM

TRACT NO. _____

AIM

[illegible]

8

Successful bidder agrees to assume full responsibility for actions, if any, relating to Worker's Compensation, public and property damage liability, and will hold Wood County harmless against any claim arising from or connected with the above mentioned operation.

E-MAIL ADDRESS

CITY, STATE, ZIP _____

CELL PHONE